

Installation Guide

M-Series Wall Mount Kit For Mortara Surveyor S12 Monitor

The purpose of this guide is to describe the M-Series wall mount installation.

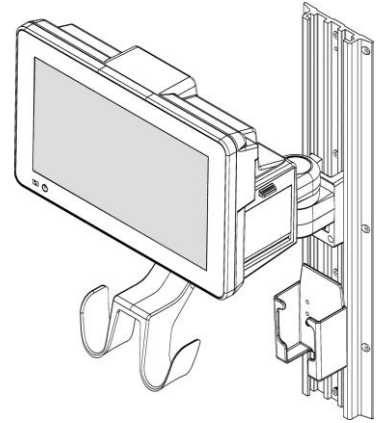

Parts Reference

The following parts and hardware are included with this installation kit (hardware not shown):

Item #	Description	Qty
1	8" M-Series Arm with Mounting Plate	1
2	19" Wall Channel (with hardware and instructions)	1
3	Quick Connect VESA Adapter	1
4	Power Supply Mount	1
5	Cable Hooks (with hardware and instructions)	1
5	Adjustable Stop	1
6	M4 x 16mm Button Head Cap Screw (BHSCS)	4
7	1/8" Hex Wrench	1
8	5/32" Hex Wrench	1
9	2.5mm Hex Wrench	1
10	16" Channel Cover (with instructions)	1

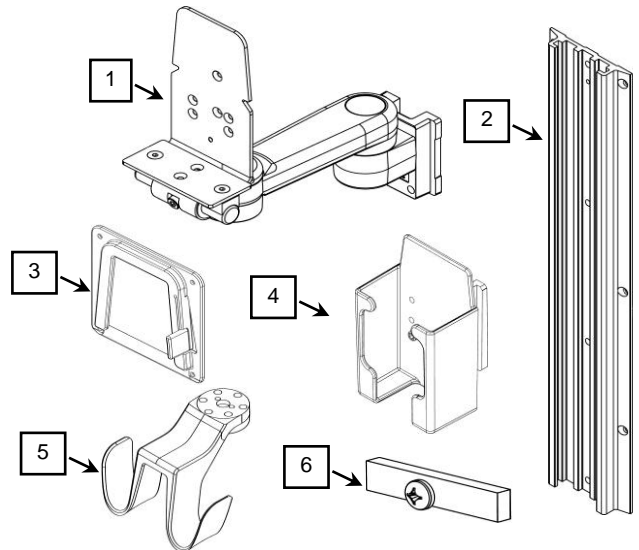

Tools Required

- Phillips screwdriver(not provided)
- 1/8" hex wrench (provided)
- 5/32" hex wrench (provided)
- 2.5mm hex wrench (provided)
- 1/2" [13mm] socket wrench (not provided)

Installation Note

Read these instructions completely before proceeding with the installation and adjustment.

Installing the Wall Channel

Install Wall Channel in accordance with Wall Channel Installation Guide DU-WC-0002 included in this kit.

Installing the Power Supply Mount

Guide the Power Supply Mount into the top of channel and slide to desired mounting position. Using a 1/8" Hex Wrench, tighten the set screw to secure position.

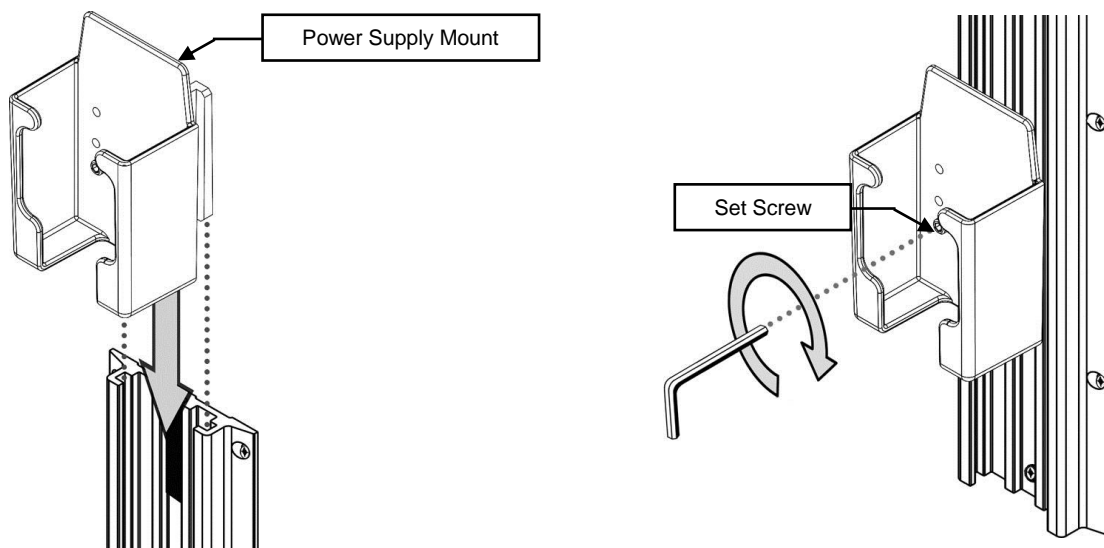

Mounting the M-Series Arm in a Channel

Insert the Adjustable Channel Stop into the top of channel and slide to desired mounting position. Tighten the center screw to secure position (below left). Install Arm by guiding Slide (rear of Arm) into top of channel. Slide Arm to desired position in channel and tighten the two (2) set screws (bottom of Slide) with the 1/8" hex wrench (provided).

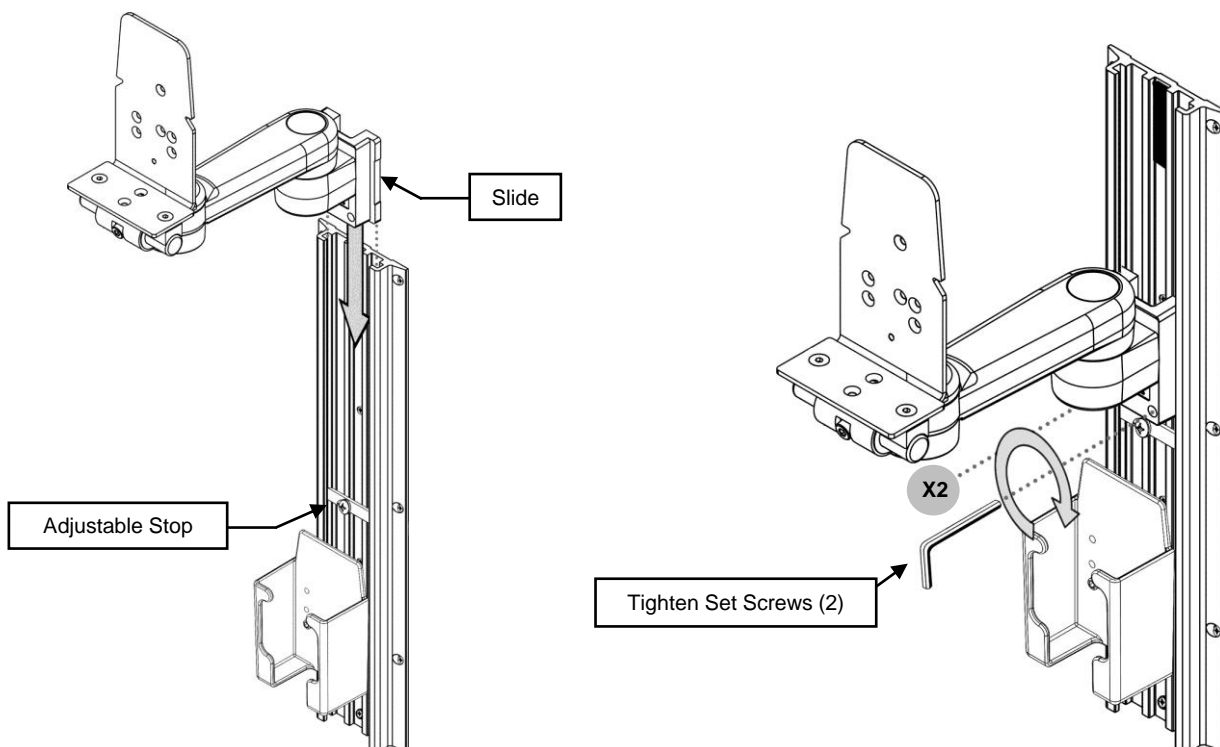

Installing the Cable Hooks

Install Cable Hooks in accordance with Cable Hook Installation Guide WMM-0006-04 included in this kit.

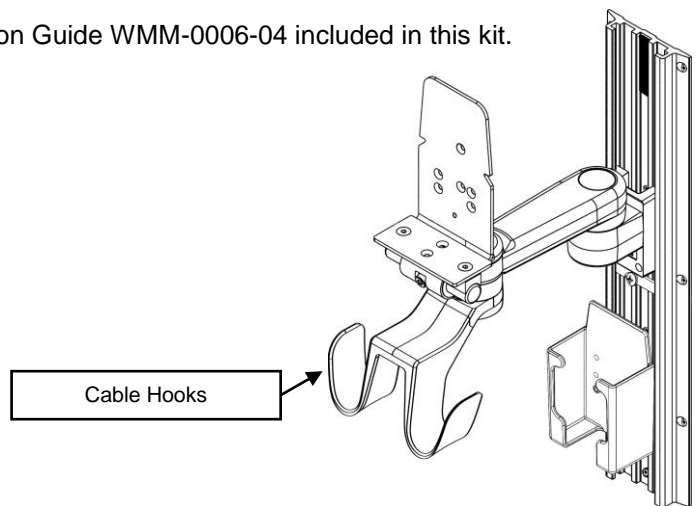

Installing the Quick Connect VESA Adapter

Using a 2.5mm hex wrench, secure VESA Adapter to the monitor with (4) M4 x 16mm BHSCS.

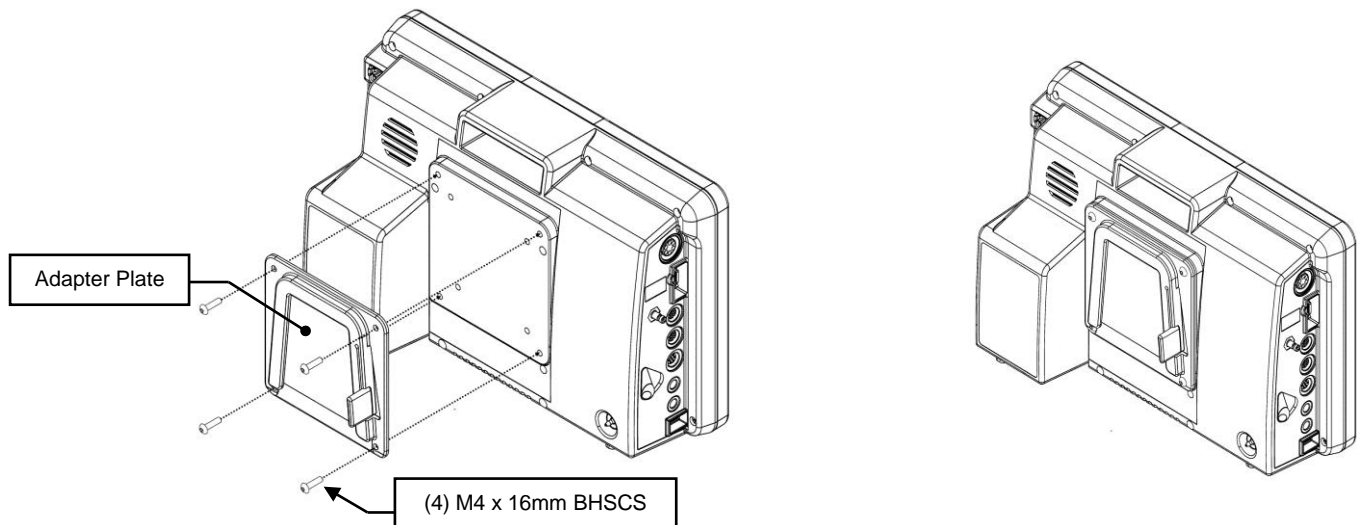

Mounting the Monitor

Guide the monitor downward onto the mounting plate until the release lever on the VESA Adapter locks into place.

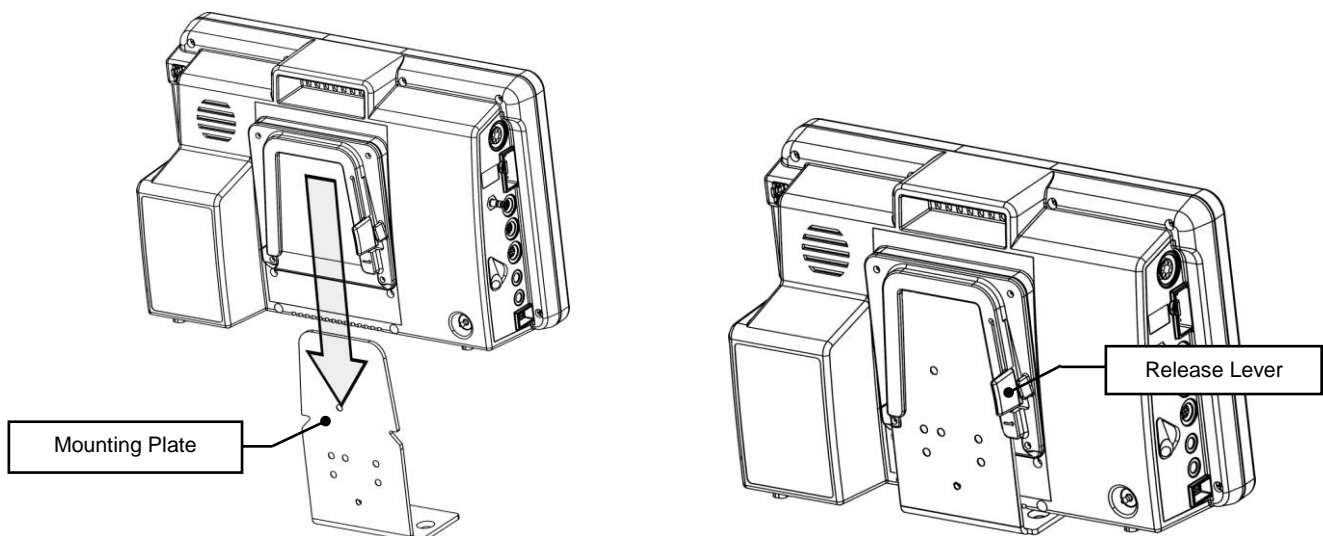

Adjusting Tilt Tension

Adjust tilt tension by tilting the mounting plate forward and equally tightening or loosening the (2) Tilt Tension Screws with the 5/32" hex wrench (provided).

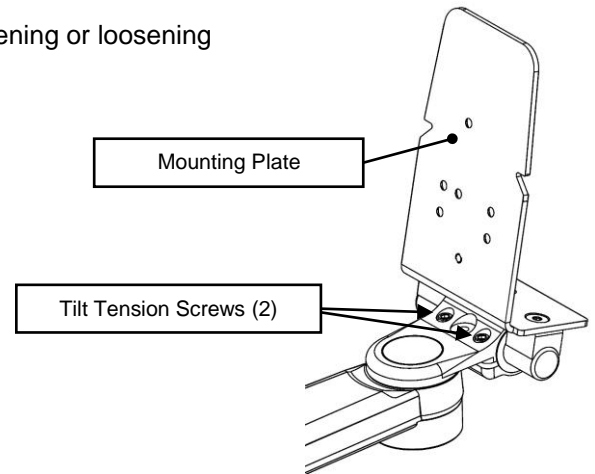

Adjusting the Swivel Tension

Remove the (3) Mounting Screws and Cable Hook assembly with the 5/32" hex wrench supplied in this kit. Using a 1/2" [13 mm] socket wrench, tighten or loosen the Swivel Tension Nut until desired tension is achieved. Re-attach Cable Hook assembly.

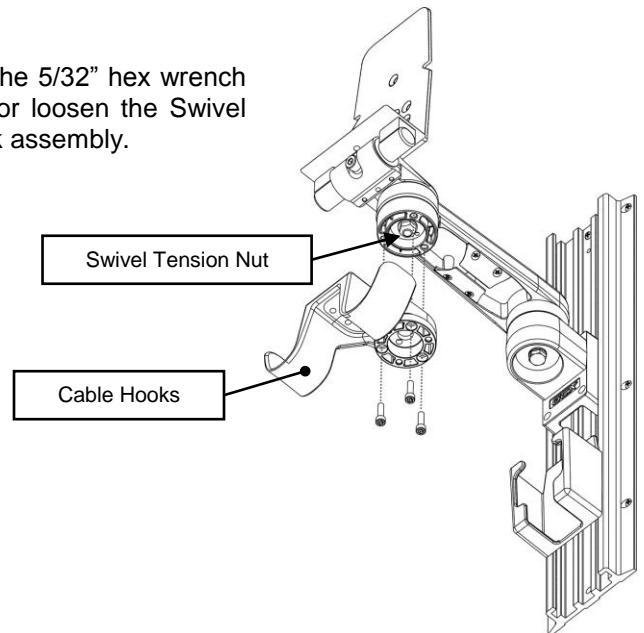

Adjusting the Pivot Tension

Using a 1/2" [13 mm] socket wrench, tighten or loosen the Pivot Tension Bolt until desired tension is achieved.

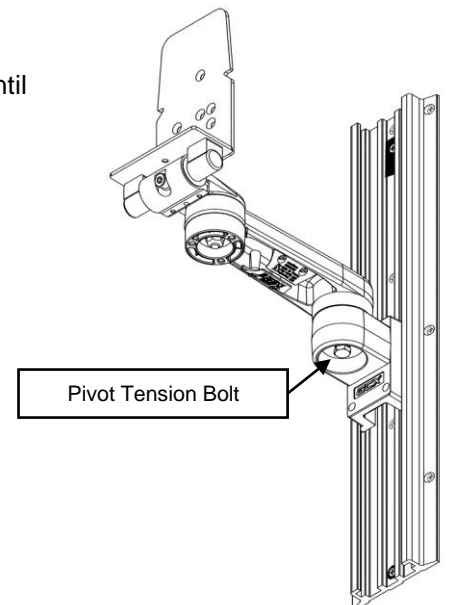

Installing the Channel Cover

Install Channel Cover in accordance with Channel Cover Installation Guide DU-UT-0001-20 included in this kit.

Routine Maintenance

Periodically inspect all fasteners associated with the mounting system. Tighten or adjust as necessary for optimal operation and safety.

Cleaning the Mounting Assembly

1. The mounting assembly may be cleaned with most mild, non-abrasive solutions commonly used in the hospital environment (e.g. diluted bleach, ammonia, or alcohol solutions).
2. The surface finish will be permanently damaged by strong chemicals and solvents such as acetone and trichloroethylene.
3. Do not use steel wool or other abrasive material to clean the mounting assembly.
4. Damage caused by the use of unapproved substances or processes will not be covered by warranty. We recommend testing of any cleaning solution on a small area of the mounting assembly that is not visible to verify compatibility.
5. Never submerge the mounting assembly or allow liquids to enter the mounting assemblies. Wipe any cleaning agents off the mounting assembly immediately using a water-dampened cloth. Dry all mounting assemblies thoroughly after cleaning.

CAUTION: GCX makes no claims regarding the efficacy of the listed chemicals or processes as a means for controlling infection. Consult your hospital's infection control officer or epidemiologist. To clean or sterilize mounted instruments or accessory equipment, refer to the specific instructions delivered with those products.