

## Installation Guide

### Upgrade Kit for Philips SureSigns Monitor – Wall Mounted M-Series or \*VHM Arm

The purpose of this guide is to describe how to perform the upgrade on an M-Series or \*VHM Arm.

\*VHM Arms with transport locking mechanism only. See CAUTION below.

#### Parts Reference

The following parts and hardware are included in this installation kit (hardware not shown):

Item #	Description	Qty
1	Receptacle, SureSigns	1
2	Adapter, Wall	1
3	Spacer, Tilt Bar	2
4	1/4-10 x 15/16" Pan Head Torx Plastite Screw	2
5	#10-32 x 3/8" Pan Head Machine Screw (PHMS)	3
6	Mounting Adapter	1
7	M4 x 12mm PHMS	4
8	M4 Split Lock Washer	4
9	Torx Bit, T30	1

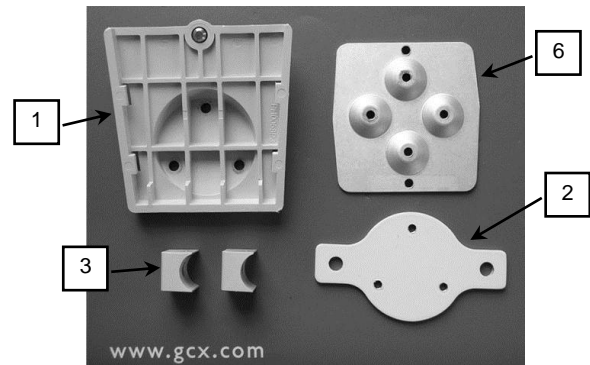

**Tools Required:** T30 Torx bit (provided) and torque wrench (not provided); Phillips screwdriver (not provided).



**CAUTION:** Do not perform upgrade on a VHM Arm with lock lever (below left). Upgrade can only be performed on a VHM arm equipped with a transport lock (below right).



Lock Lever

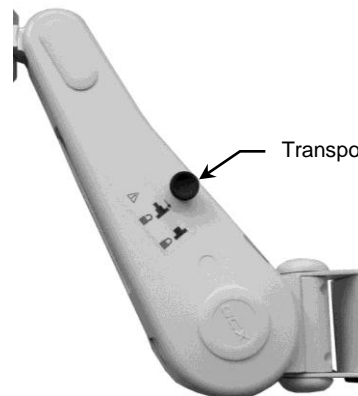

Transport Lock

## Performing the Upgrade

**Installation Note:** The upgrade procedure is identical for either the M-Series or VHM Arm. Only the M-Series installation is shown in this installation guide. The upgrade procedure is easier to perform while the arm is mounted in a channel.

1. Using the T30 Torx bit provided, unscrew and remove the plunger plate from the tilt bar on the arm.

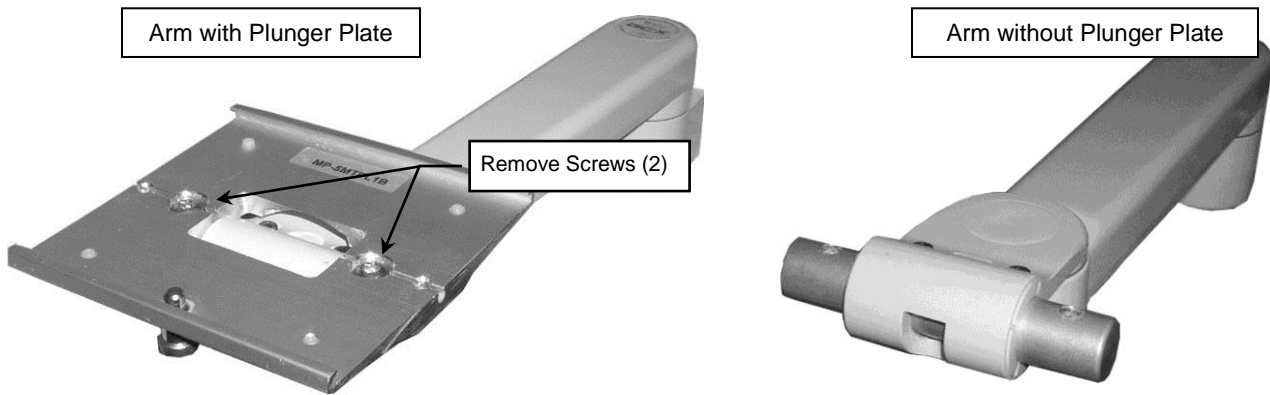

2. Align parts as shown below. Note orientation of 3-hole mounting pattern on Wall Adapter. Using the T30 Torx bit provided, fasten parts to tilt bar with two (2) 1/4-10 x 15/16" PH Torx plastite screws and torque to 150 in/lbs (17 Nm) as shown below left.
3. Align Receptacle with 3-hole mounting pattern on Mounting Adapter. Fasten Receptacle to Mounting Adapter with three (3) #10-32 x 3/8" PHMS as shown below right.

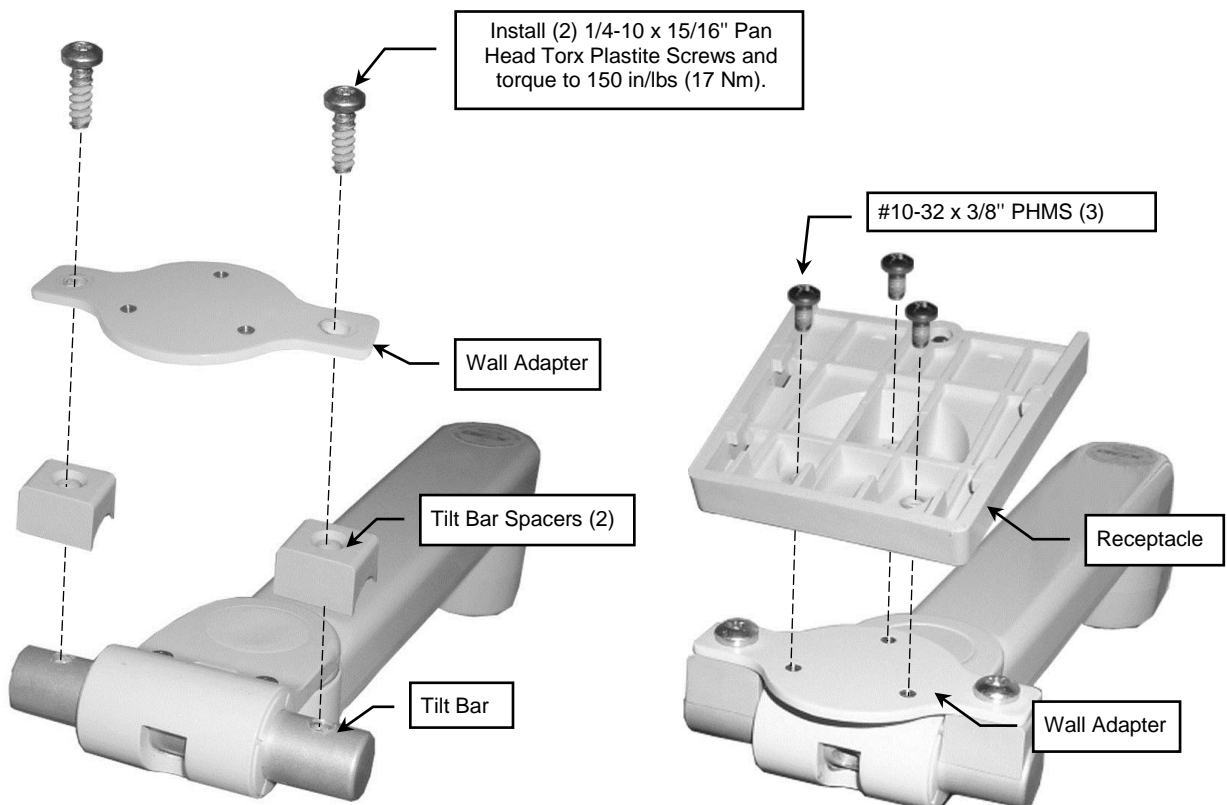

4. Orient the Mounting Adapter with alignment holes toward front and rear (see callout below). Fasten Adapter to bottom of monitor with four (4) M4 x 12mm PHMS and M4 Lock Washers (A) or three (3) M4 x 12mm PHMS and M4 Lock Washers (B) as shown.

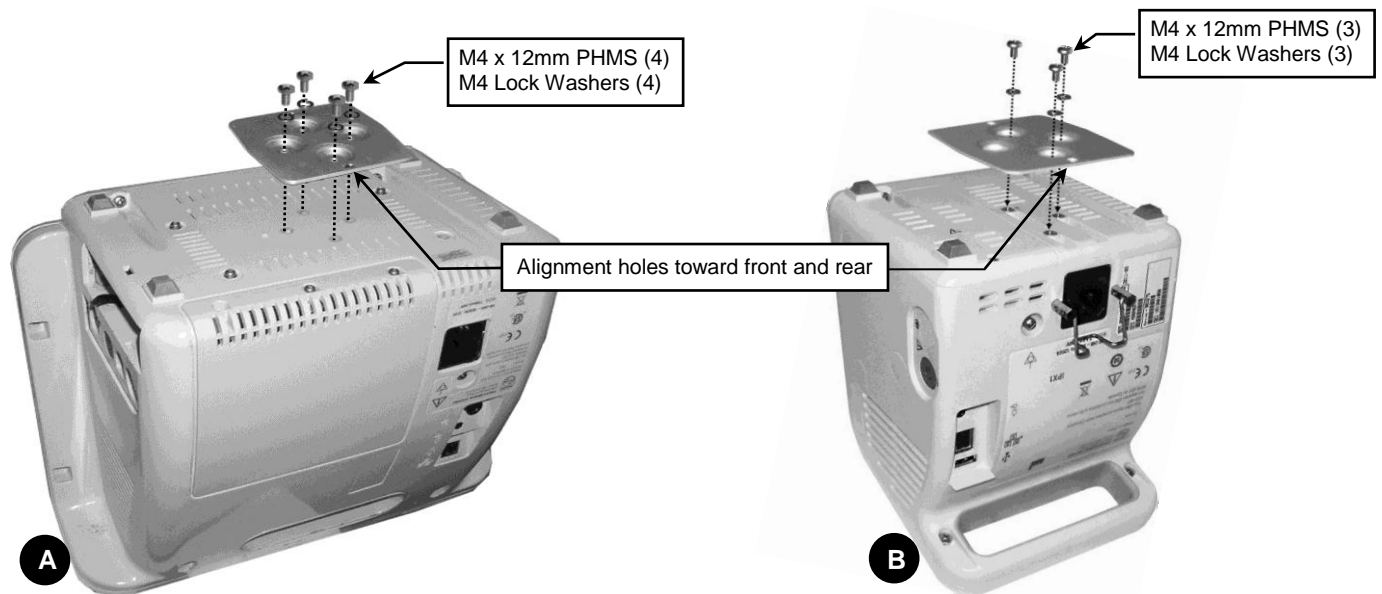

### Mounting the Monitor

1. Slide Mounting Adapter into Receptacle from the rear as shown below left.
2. Tighten Thumbscrew at rear of Receptacle (below right).

