

## Installation Guide VHM-25 for Philips X3

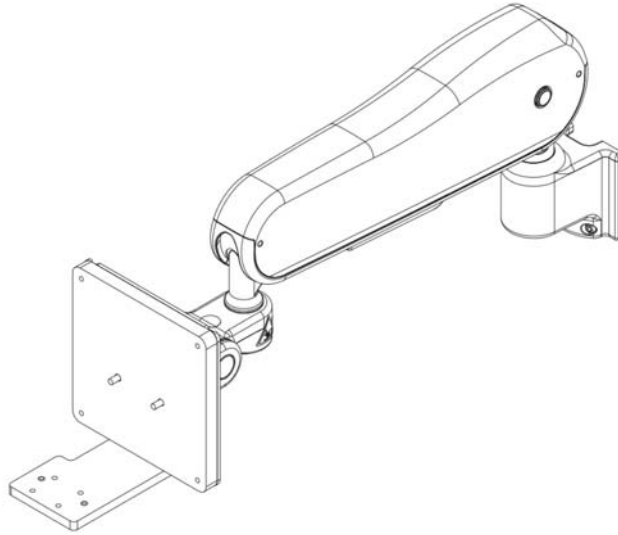

The maximum load rating for the accessory track is 20 lbs. [9.07 Kg].

### Parts Reference

The following parts and hardware are included in this installation kit (Hardware not shown):

Item #	Description	Qty.
1	VHM-25 Adaptor	1
2	M4 X 10 Pan Head Machine Screw (PHMS)	4
3	M4 X 16 Flat Head Machine Screw (FHMS)	2
4	8-32 X 5/16" Pan Head Machine Screw (PHMS)	2
5	VHM25 Handle (Shown but not included)	1
6	3 Hook Kit (Shown but not included)	1

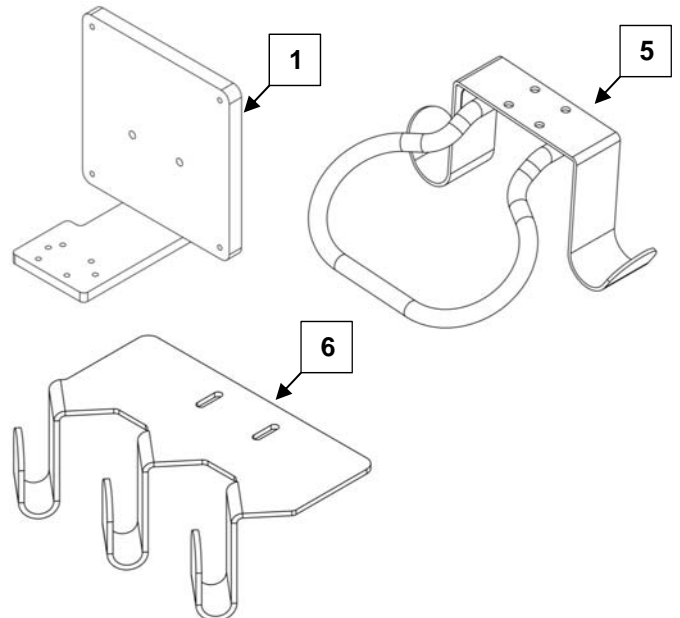

### Tools Required:

- Philips Screwdriver (not provided)

## Attaching the Mounting Plate (supplied by Philips) to the Arm

1. Using the two (2) M4 X 16mm FHMS, tighten the screws as shown below.

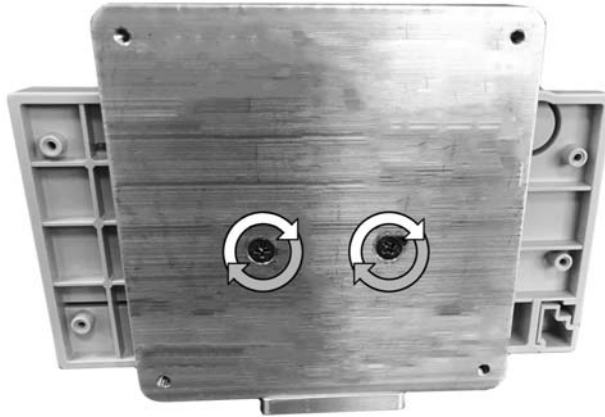

2. Thread two (2) M4 X 10mm PHMS into the top two (2) threaded holes of the VESA mounting pattern located on the back of the adaptor, leaving 4mm of thread exposed.



3. Place the remaining two (2) M4 x 10mm PHMS on the bottom holes, and evenly tighten the four (4) M4 X 10mm PHMS.



## Attaching Intellive Dock (supplied by Philips) to the Arm

1. Using the two (2) M4 X 16mm FHMS provided, tighten the screws as shown below.



2. Thread two (2) M4 X 10mm PHMS into the top two (2) threaded holes of the VESA mounting pattern located on the back of the adaptor, leaving 4mm of thread exposed.



3. Place the remaining two (2) M4 x 10mm PHMS on the bottom holes, and evenly tighten the four (4) M4 X 10mm PHMS.



## Attaching Handle or Hook Adaptor

1. For “3 hook”, use two (2) 8-32 X 5/16” PHMS provided, tighten screws in desired position as shown below (left picture).  
**(Do not use pre-supplied screws with Hooks).**
2. For VHM25 Handle, use four (4) 8-32 x 5/16” PHMS provided with handle/hook kit, tighten screws in pre-set holes as shown below (right picture).



### Routine Maintenance

Periodically inspect all fasteners associated with the mounting assembly. Tighten or Adjust as necessary for optimal operation and safety.

### Cleaning the Mounting Assembly

The mounting assembly may be cleaned with most mild, non-abrasive solutions commonly used in the hospital environment (e.g. diluted bleach, ammonia, or alcohol solutions).

The surface finish will be permanently damaged by strong chemicals and solvents such as acetone or trichloroethylene.

Steel wool or other abrasive material should never be used.

Damaged caused by the use of unapproved substances or processes will not be warranted. We recommend testing of any cleaning solution on a small area of the mounting assembly that is not visible to verify compatibility.

Never submerge or allow liquids to enter the mounting assembly. Wipe any cleaning agents off the mounting assembly immediately using a water-dampened cloth. Dry the assembly thoroughly after cleaning.



**CAUTION:** GCX makes no claims regarding the efficacy of the listed chemicals or processes as a means for controlling infection. Consult your hospital's infection control officer or epidemiologist. To clean or sterilize mounted devices or accessory equipment, refer to the specific instructions delivered with those products.