

Installation Guide

Bottom Mounted Counterweight Kit For Penlon Anesthesia Machine



The purpose of this guide is to describe the installation of the Counterweight to the anesthesia machine.



WARNING! The installation of the two (2) 30 lb. [13.6 kg] Weight Bars requires two (2) people. Failure to heed this warning could result in injury to personnel or damage to equipment. Both Weight Bars in this installation kit must be installed to prevent tipping of the anesthesia machine.



Installation Note: Counterweight Kit (DR-0014-05) Must be ordered with this kit.

Parts Reference

The following parts and hardware will be used in this installation (hardware not shown):

Included in this kit (PNL-0001-03).

Item #	Description	Qty
1	Mounting Bracket	2
2	M8 x 30 mm Socket Head Cap Screw (SHCS)	4
3	Counterweight Cover	1
4	#10-32 Kep Nut	2
5	6 mm Hex Wrench	1

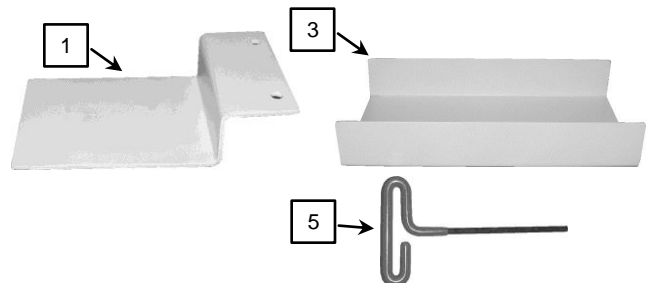

Included in kit (DR-0014-05) ordered separately.

Item #	Description	Qty
1	Weight Bar	2

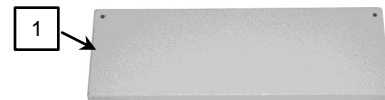

Tools required: 6 mm Hex Wrench (provided), 3/8" wrench (not provided).

Installing Counterweight on Bottom of Anesthesia Machine

To install the Counterweight, follow instructions in callouts beginning below. Photos are taken from the bottom rear of the machine.

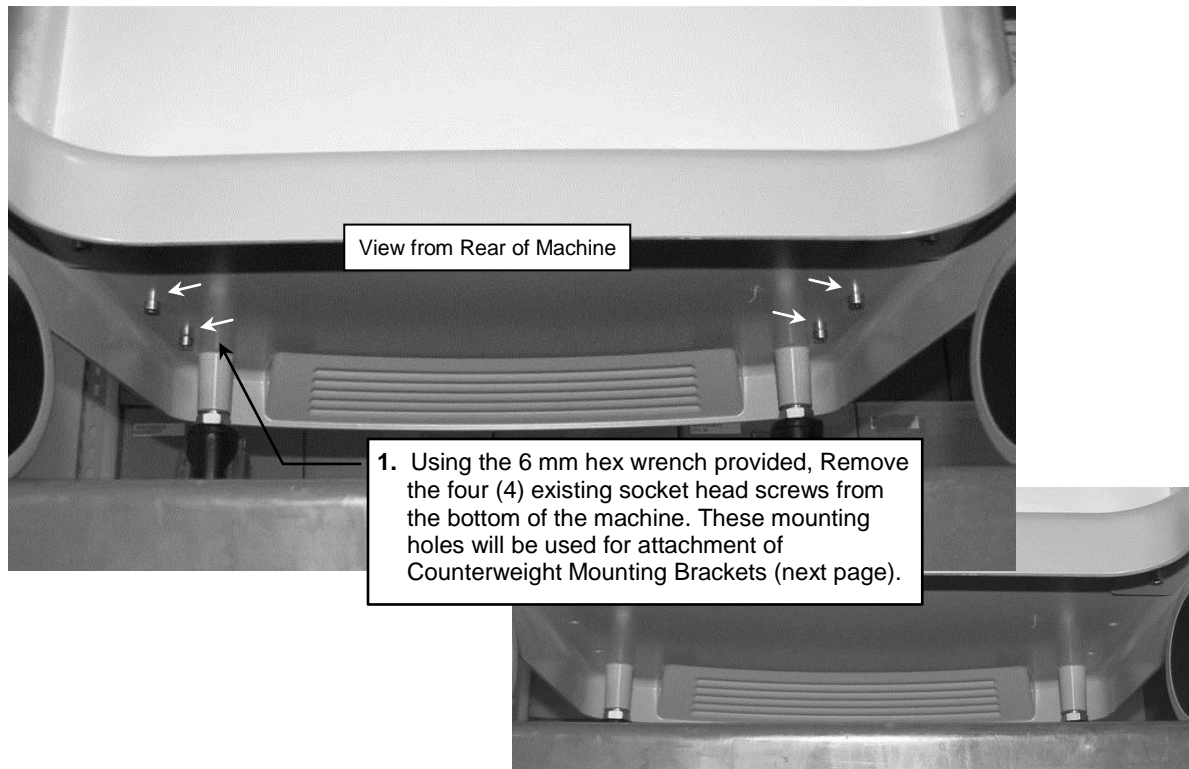

Mounting Bracket (x 2)

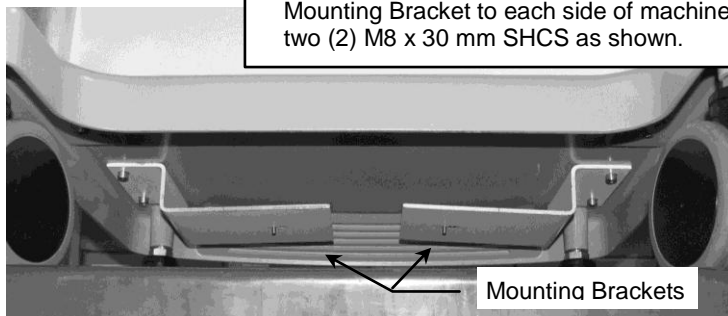
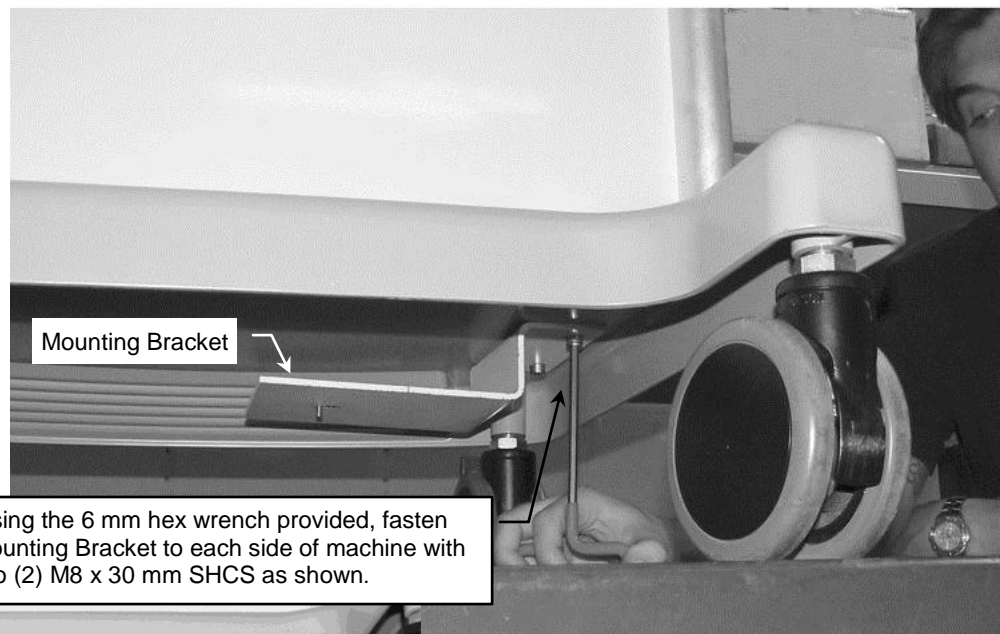

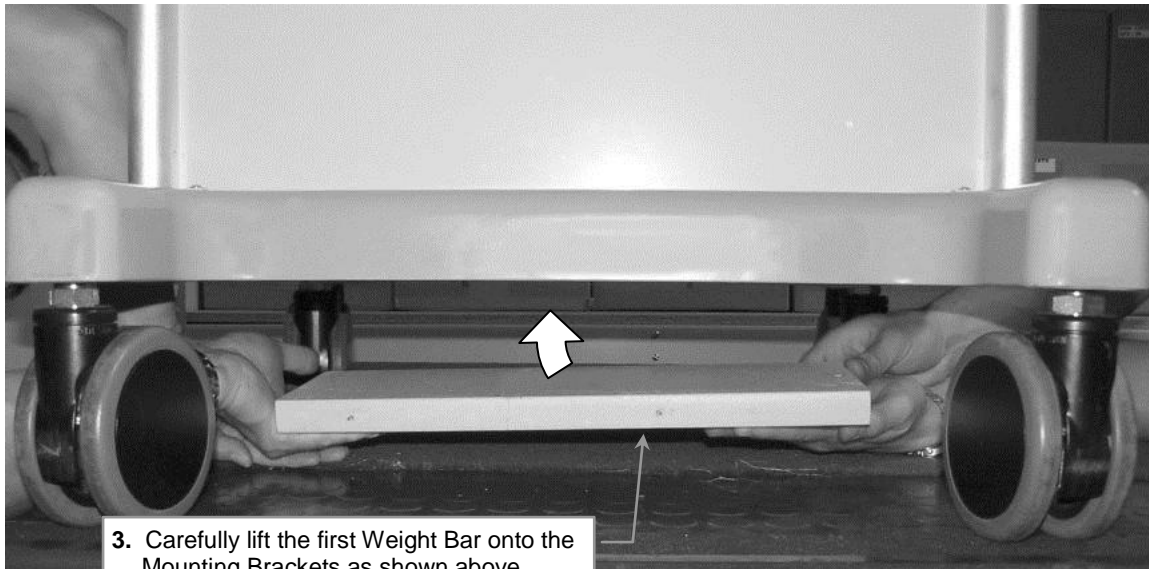

3. Carefully lift the first Weight Bar onto the Mounting Brackets as shown above.



Counterweight Bar

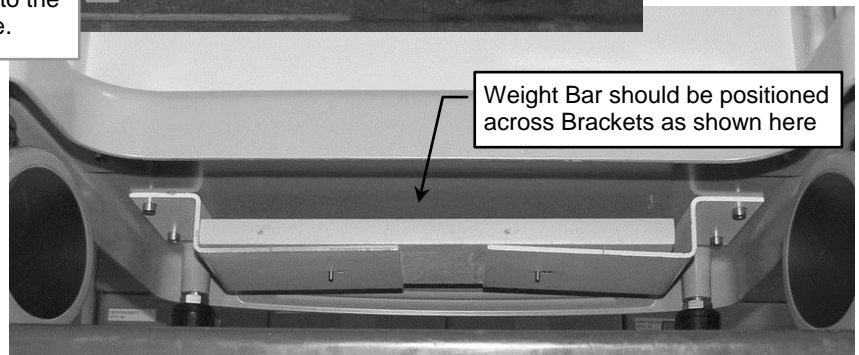

Weight Bar should be positioned across Brackets as shown here

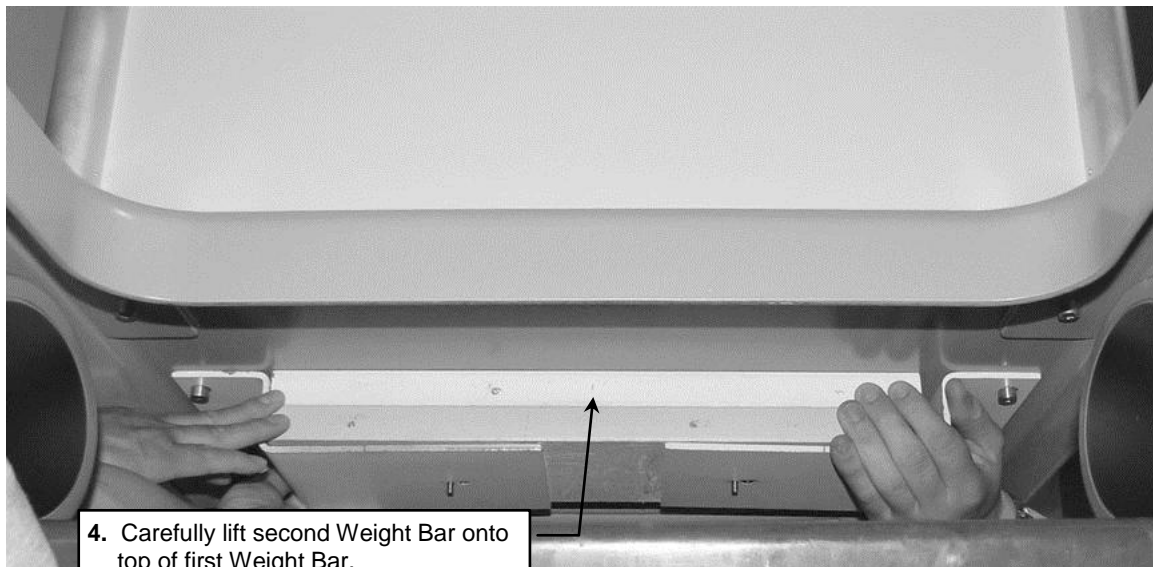

4. Carefully lift second Weight Bar onto top of first Weight Bar.

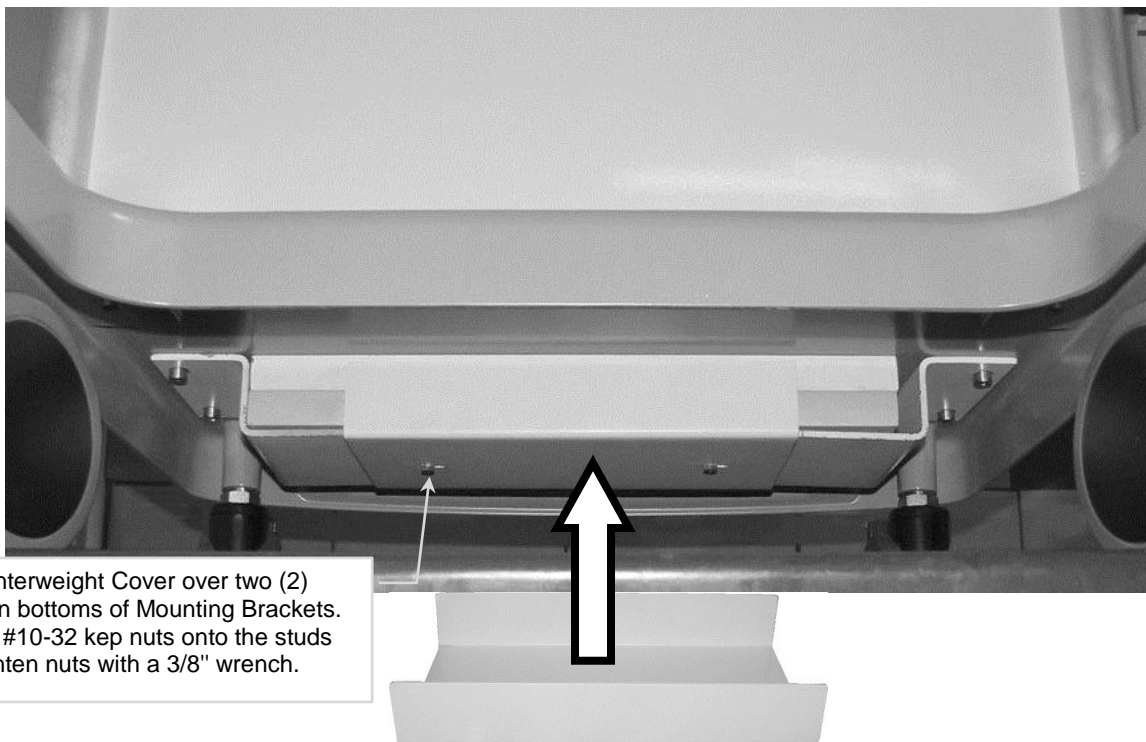

Routine Maintenance

Periodically check all mounting hardware. Tighten as necessary for optimal operation.

Cleaning the Mounting Assembly

CAUTION: GCX makes no claims regarding the efficacy of the listed chemicals or processes as a means for controlling infection. Consult your hospital's infection control officer or epidemiologist. To clean or sterilize mounted instruments or accessory equipment, refer to the specific instructions delivered with those products.

1. The mounting assembly may be cleaned with most mild, non-abrasive solutions commonly used in the hospital environment (e.g. diluted bleach, ammonia, or alcohol solutions).
2. The surface finish will be permanently damaged by strong chemicals and solvents such as acetone and trichloroethylene.
3. Do not use steel wool or other abrasive material to clean the mounting assembly.
4. Damage caused by the use of unapproved substances or processes will not be covered by warranty. We recommended that you test any cleaning solution on a small area of the mounting assembly that is not visible to verify compatibility.
5. Never submerge or allow liquids to enter the mounting assemblies. Wipe any cleaning agents off of the mounting assemblies immediately, using a water-dampened cloth. Dry mounting assemblies thoroughly after cleaning.