

**GCX Mounting Assembly Installation Guide****M-Series Wall Mount Kit for Welch Allyn Vital Signs Monitor 300 Series**

*The purpose of this guide is to describe installation of Wall Mount Kit.*

**Parts Reference**

The parts list below includes parts and hardware that will be used in this installation procedure (hardware not shown).

Item #	Description	Qty
1	Wall Channel Kit, 19" (includes instructions - not shown)	1
2	M-Series Arm with Mounting Adapter, 8"	1
3	Utility Basket	1
4	Adjustable Stop	2
5	18" Strap, Hook and Loop (not shown)	2
6	1/8" Hex Wrench	1
7	Wall Channel Cover, 16" (includes instructions – not shown)	1

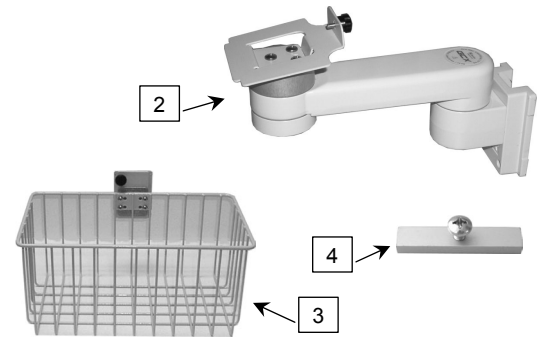

**Tools Required:** Phillips screwdriver, 1/8" hex wrench (provided).

**Installation of Wall Mount Kit**

1. Install Wall Channel in accordance with *GCX Wall Channel Installation Instructions (DU-WC-0002)*.
2. Insert one (1) Adjustable Stop in top of Channel and let it slide to rest against Fixed Stop at bottom of Channel (photo below left).
3. Install Utility Basket by inserting Slide (rear of Basket) into top of Channel and sliding Basket to desired mounting position (below center). Tighten black Knob (top of Slide) to secure Basket in position. Slide Adjustable Stop up Channel to bottom of Basket Slide and tighten center screw in Adjustable Stop.
4. Insert remaining Adjustable Stop in Channel and let it slide to top of Basket Slide (below right).

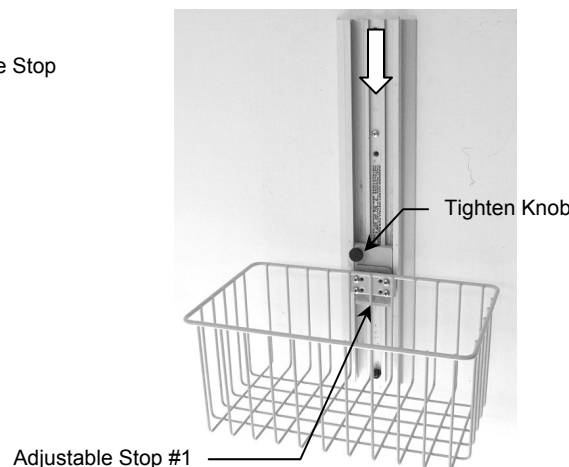
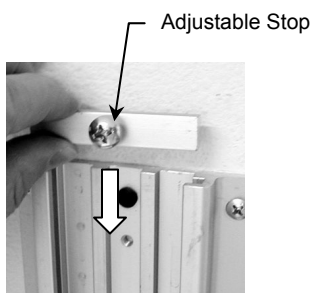

5. Install Arm by guiding Slide (rear of Arm) into top of Channel (below left). Slide Arm to desired position in channel and tighten two (2) set screws (bottom of Slide) using 1/8" hex wrench provided (below center). Slide Adjustable Stop #2 to bottom of Slide and tighten center screw in Adjustable Stop (below right).

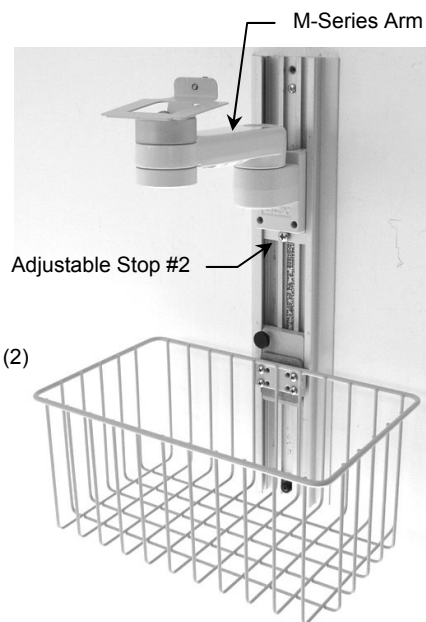
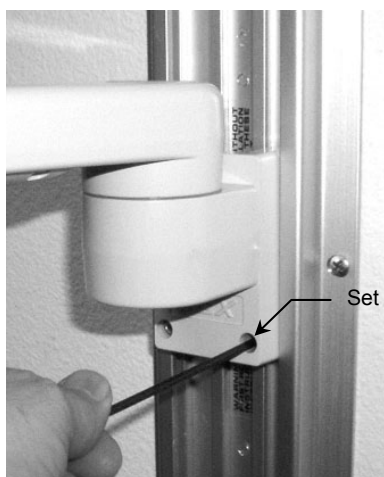
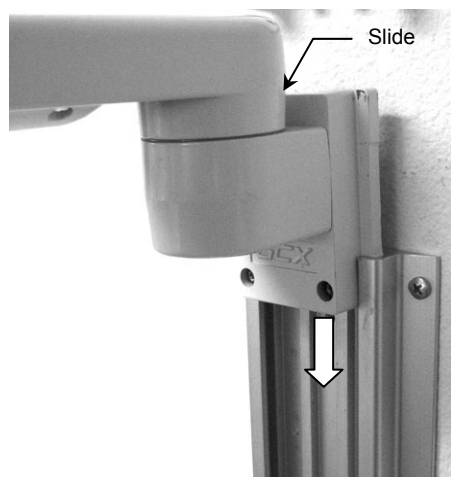

6. Slide monitor onto Mounting Adapter (below left), ensuring that tab at front of Adapter is inserted in slot on bottom of monitor. Thread Thumbscrew (rear of Mounting Adapter) into threaded hole in rear of monitor and tighten (below center).
7. Mount power supply on top of Arm using Hook-and-Loop Straps as shown in photos below right. **CAUTION:** Do not cover power supply vent holes with Strap when mounting small power supply.

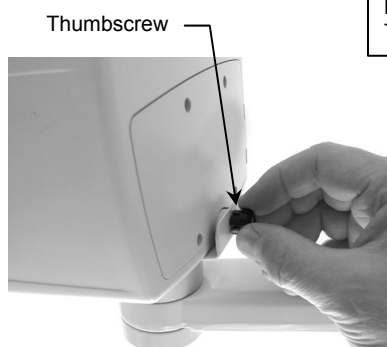

Mount **Large** Power Supply with Two (2) Hook & Loop Straps.

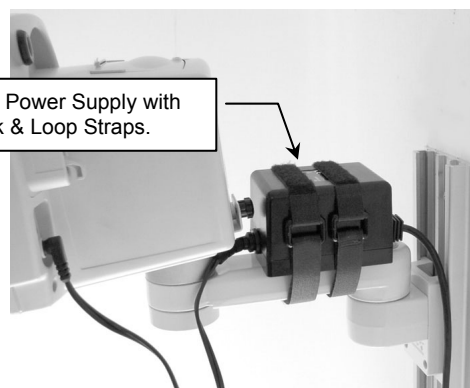

Mount **Small** Power Supply with One (1) Hook & Loop Strap.

**CAUTION:** Do Not Cover Power Supply Vent Holes with Strap.

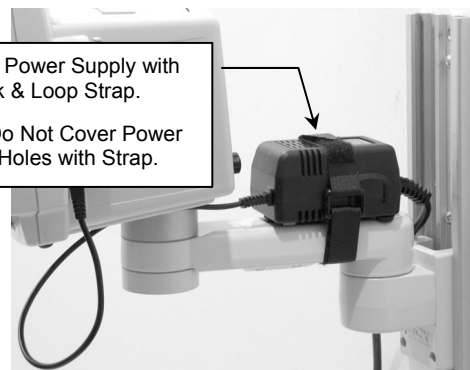

8. Install Wall Channel Cover in accordance with *Channel Cover Installation Guide (DU-UT-0001-20)*.

## Arm Adjustments

Pivot and Swivel Tension Bolts are shown in photo below.

### Swiveling the Monitor

Grasp sides of monitor and swivel to desired position.

### Adjusting Swivel Tension

Using 1/2" [13 mm] socket wrench, tighten or loosen Swivel Tension Nut for desired swivel resistance.

### Pivoting the Arm

Push or pull on side of Arm.

### Adjusting Pivot Tension

Using 1/2" [13 mm] socket wrench, tighten or loosen Pivot Tension Bolt for desired pivot resistance.

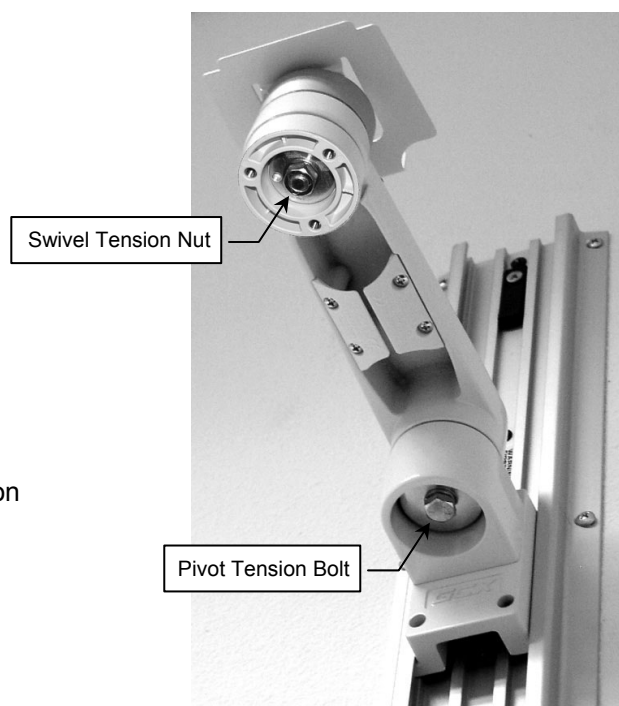

## Routine Maintenance

Periodically inspect all hardware associated with the mounting system. Tighten or adjust as necessary for optimal operation and safety.

### Cleaning the Mounting Assembly

1. The mounting assembly may be cleaned with most mild, non-abrasive solutions commonly used in the hospital environment (e.g. diluted bleach, ammonia, or alcohol solutions).
2. The surface finish will be permanently damaged by strong chemicals and solvents such as acetone and trichloroethylene.
3. Do not use steel wool or other abrasive material to clean the mounting assembly.
4. Damage caused by the use of unapproved substances or processes will not be covered by warranty. We recommend testing of any cleaning solution on a small area of the arm that is not visible to verify compatibility.
5. Do not submerge or allow liquids to enter the arm. Wipe any cleaning agents off of the arm immediately using a water-dampened cloth. Dry the arm thoroughly after cleaning.

**CAUTION:** GCX makes no claims regarding the efficacy of the listed chemicals or processes as a means for controlling infection. Consult your hospital's infection control officer or epidemiologist. To clean or sterilize mounted instruments or accessory equipment, refer to the specific instructions delivered with those products.